

**Main Floor**  
1376 sqft.

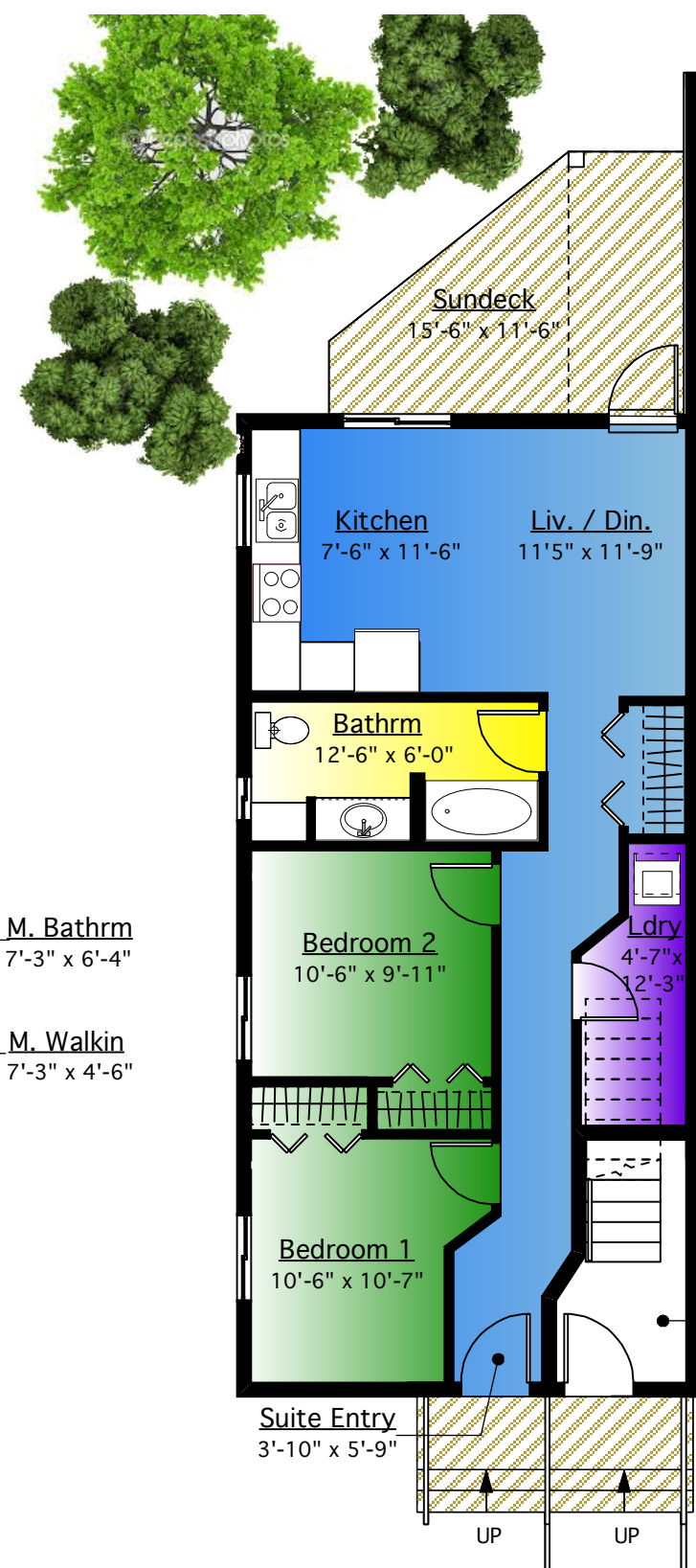

**Lower Floor**  
Suite 789 sqft.  
Garage 828 sqft

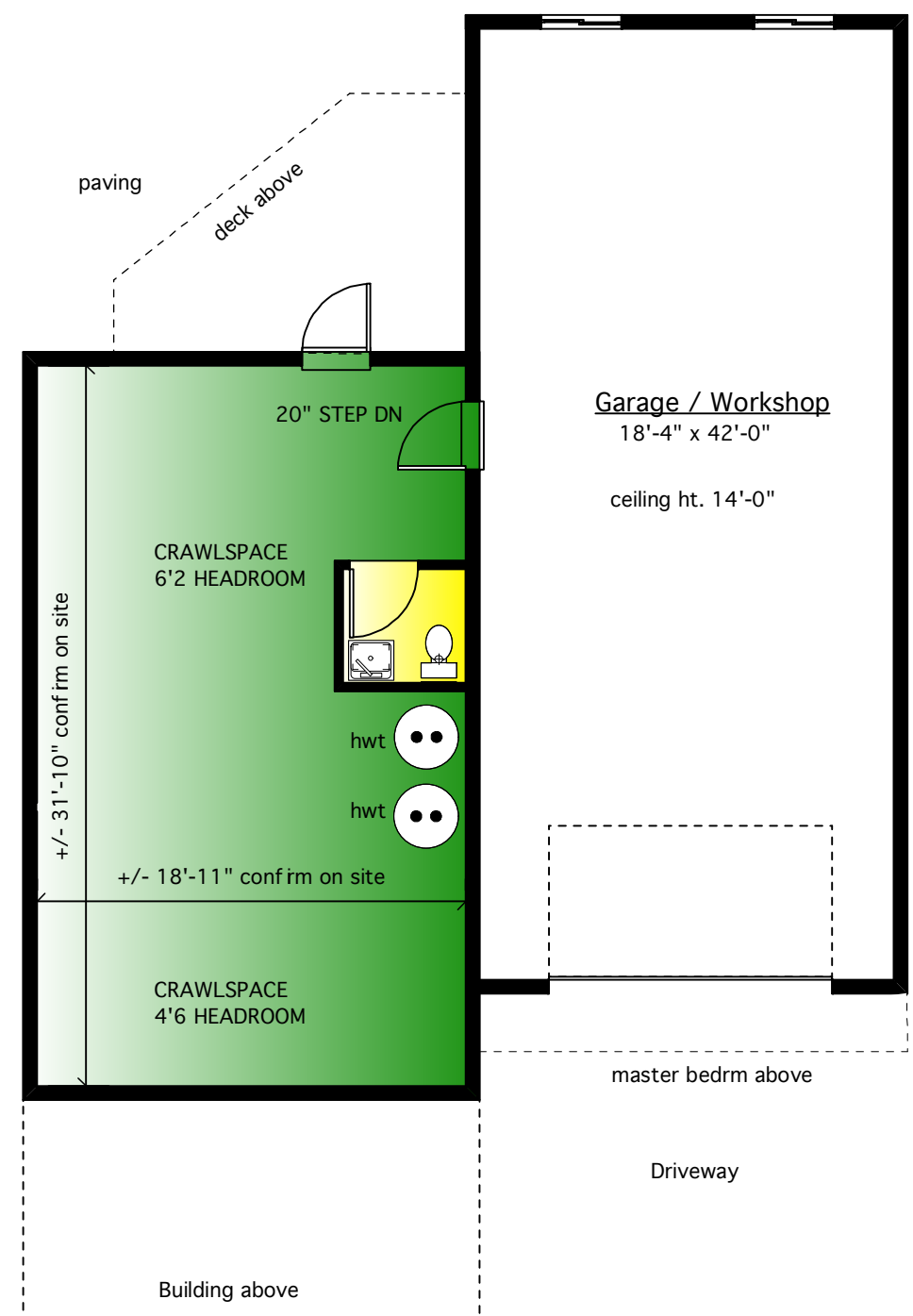
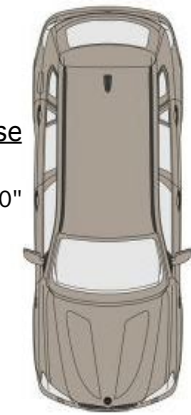

**Crawlspace**

**RE/MAX OF NANAIMO**  
Independently Owned & Operated

**RH RICK HORSLAND**  
a leader in residential sales

office 250.751.1223 . toll free 1.866.697.4948 . fax 250.751.1300 . email rick@rickhorland.com . web rickhorland.com

drawings copyright by:  
f inn & assoc. design ltd.  
#206 - 3150 North Island Hwy  
250.739.8854 www.finnassoc.com

## 742 Railway Ave., Nanaimo, BC

prepared for the exclusive use of Rick Horland  
buyer to verify all dimensions and areas

Floor	Finished	Garage	Deck/Patio
Main (Upper)	1376	0	294
Lower	789	828	135
Crawlspace	0	666	479
Totals	2165	1494	908